

# E12237



## Connecting cable with socket

ADOAH080MSS0015B08

For 8-pole sockets the core colours are not standardised.  
Please note the wiring of the sensor and the sockets (see data sheet).

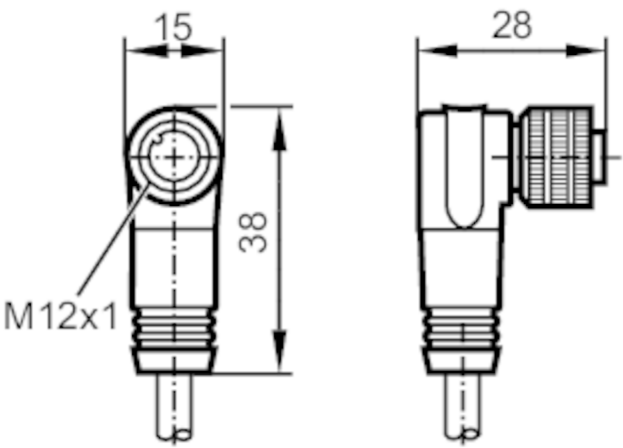

| Electrical data         |      |                      |
|-------------------------|------|----------------------|
| Operating voltage       | [V]  | < 30 AC / < 36 DC    |
| Max. current load total | [A]  | 2                    |
| Operating conditions    |      |                      |
| Ambient temperature     | [°C] | -40...80             |
| Protection              |      | IP 68                |
| Mechanical data         |      |                      |
| Weight                  | [g]  | 813.5                |
| Dimensions              | [mm] | 28 x 15 x 38         |
| Materials               |      | TPU                  |
| Moulded-body material   |      | TPU                  |
| Material nut            |      | brass, nickel-plated |
| Remarks                 |      |                      |
| Pack quantity           |      | 1 pcs.               |

# E12237



## Connecting cable with socket

ADOAH080MSS0015B08

### Electrical connection

Cable: 15 m, PUR, black; 8 x 0.25 mm<sup>2</sup> (32 x Ø 0.1 mm )

### Electrical connection - socket

Connector: 1 x M12, angled; coding: A; Moulded body: TPU; Locking: brass, nickel-plated; Tightening torque: 1...1.5 Nm



### Connection

|   |    |
|---|----|
| 1 | WH |
| 2 | BN |
| 3 | GN |
| 4 | YE |
| 5 | GY |
| 6 | PK |
| 7 | BU |
| 8 | RD |

colours to DIN  
47100

|      |        |
|------|--------|
| BN = | brown  |
| BU = | blue   |
| GN = | green  |
| GY = | grey   |
| PK = | pink   |
| RD = | red    |
| WH = | white  |
| YE = | yellow |

Core colours :